

Crocodile Clip, Flanged, Fully Insulated

Features

- UL/CSA Compliant
- Accepts All Standard 4mm Test Lead Plugs
- Offset Jaw & Special Tooth Design Grips Small and Large Diameter Test Points Securely



TL-010

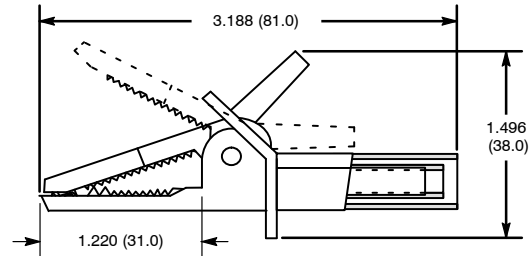

| NTE Type No. | Color | Diag No. |
|--------------|-----------------------------------|----------|
| 72-053 | Black | TL-010 |
| 72-054 | Red | TL-010 |
| 72-054-KIT | Contains 1 ea. of 72-053 & 72-054 | |

Specifications

IEC 1010 Rating: 1000V CAT2 / 600V CAT3 20 Amps
 Maximum Jaw Opening: .945" (24mm)

NEW

Crocodile Clip, Small, Fully Insulated

Features

- Accepts All Standard 4mm Test Lead Plugs
- Small Size is Ideal for Connecting to Confined Test Points



TL-011

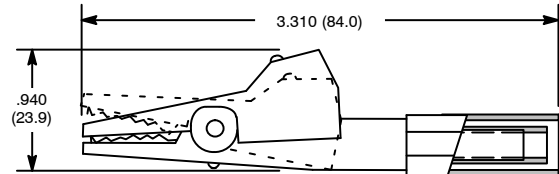

| NTE Type No. | Color | Diag No. |
|--------------|-----------------------------------|----------|
| 72-055 | Black | TL-011 |
| 72-056 | Red | TL-011 |
| 72-056-KIT | Contains 1 ea. of 72-055 & 72-056 | |

Specifications

Rating: 1000V CAT2, 20 Amps
 Maximum Jaw Opening: .275" (7mm)

NEW

Crocodile Clip, Large, Fully Insulated

Features

- UL/CSA Compliant
- Accepts All Standard 4mm Test Lead Plugs
- Wide Jaw Opening & Special Tooth Design Assures Firm Grip and Electrical Contact



TL-012

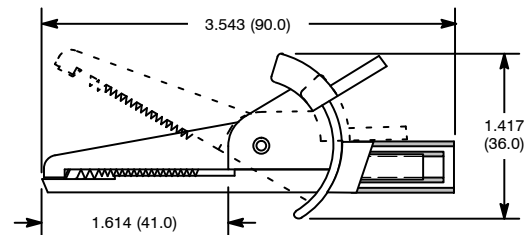

| NTE Type No. | Color | Diag No. |
|--------------|-----------------------------------|----------|
| 72-057 | Black | TL-012 |
| 72-058 | Red | TL-012 |
| 72-058-KIT | Contains 1 ea. of 72-057 & 72-058 | |

Specifications

IEC 1010 Rating: 1000V CAT3 / 600V CAT4 30 Amps
 Maximum Jaw Opening: .866" (22mm)

NEW

Crocodile Clip, Screw Type

Features

- CE Compliant
- Compliant with EN61010-031 / A1:2008
- For Use With 1000V Fused Probe Bodies



TL-013

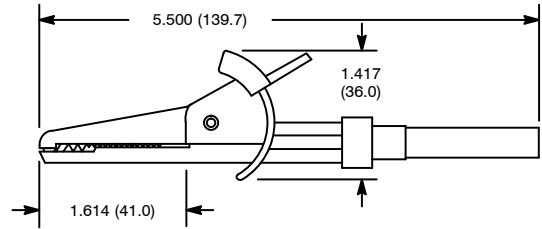

| NTE Type No. | Color | Diag No. |
|--------------|-----------------------------------|----------|
| 72-059 | Black | TL-013 |
| 72-060 | Red | TL-013 |
| 72-060-KIT | Contains 1 ea. of 72-059 & 72-060 | |

Specifications

IEC 1010 Rating: 1000V CAT3

Rated Current: 10A

Maximum Jaw Opening: .866" (22mm)